

# MANISCOPIC Equipment

## ■ *Tipping Fork Carrier (PFB)*

- Height: 725 mm
- Several widths
- Suitable for all types of pallets
- 2 forks with 1200 mm tenons
- Options: backboard and fork extensions

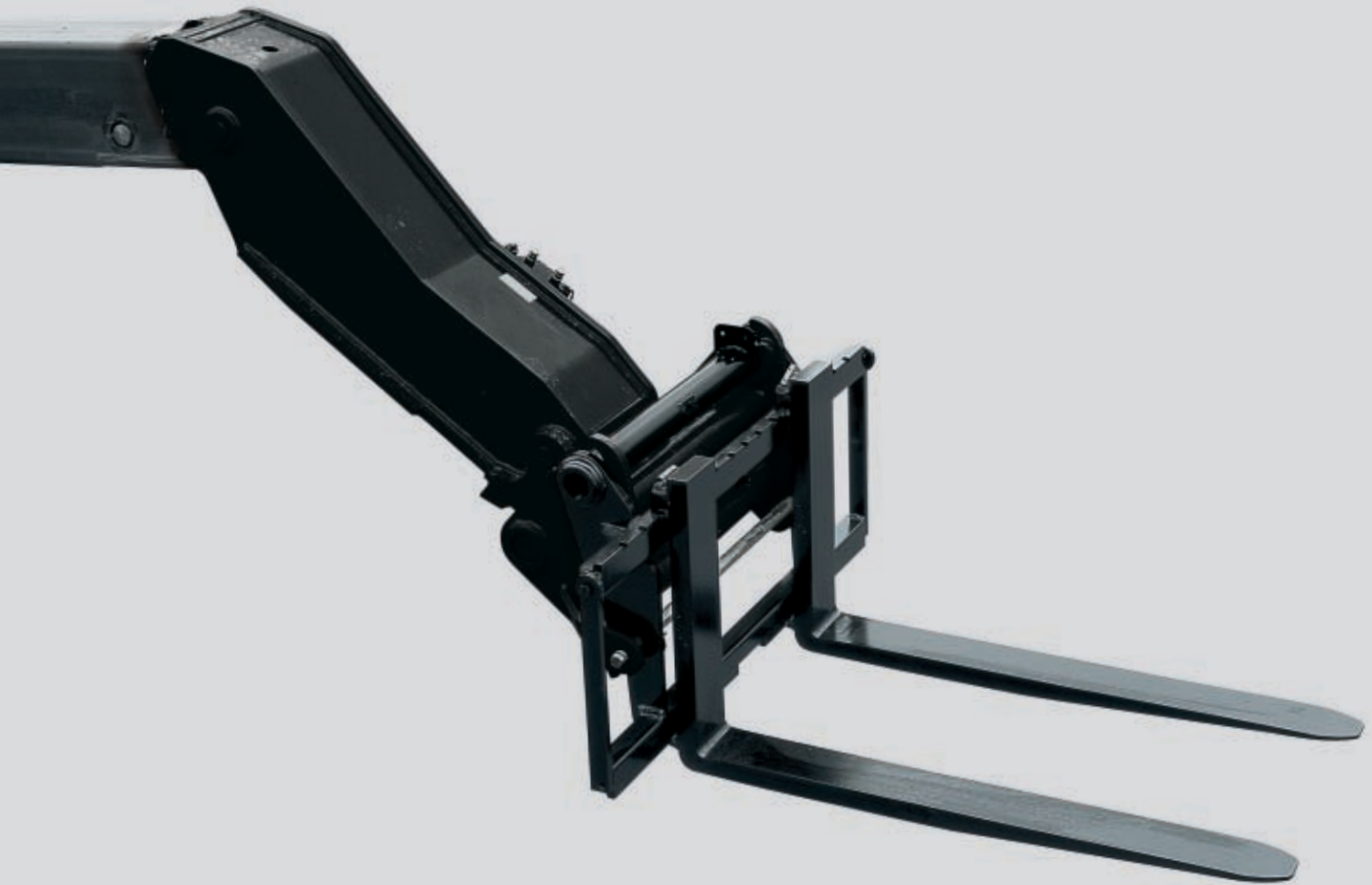

Equipment designed to European standards and to the specifications of your Maniscopic

The tipping fork carrier is as compact as it is practical. With it, you can easily handle pallets, sacks of seed, pallet-crates of fruit or potatoes, etc.

Its system of forks is certified according to FEM classifications.



The tipping fork carrier comes in **3 models**: for MANISCOPIC with capacities less than 2.5 T, for those with capacities between 2.5 T and 3.5 T and for those with capacities greater than 3.5 T.

These models are available in various widths:

- 1020 and 1260 mm for the model PFB 25
- 1260, 1470 and 1580 mm for the model PFB 35
- 1260, 1670 and 2000 mm for the model PFB 45

Its spacing system gives you several widths; the forks can be moved and are held in place by catches, for optimum safety.



**MANITOU** offers you an optional backboard, fork extensions (1.70 m to 2.50 m) and an integral shifting carriage, directly adaptable once the forks have been removed.

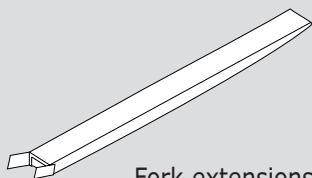

Fork extensions

To find out which equipment suits your MANISCOPIC, get in contact with your dealer.  
The specifications shown here are not binding on the manufacturer and may be altered without notice.



# MANISCOPIC Equipment

## Carriage For Floating Forks (TFF)

- Height 945 mm
- Widths 1040 and 1300 mm
- 2 forks with eyes, 1200 mm long
- Distance between forks can be adjusted with high precision
- Used for picking up pallets from uneven ground

OPTION: Floating forks with integrated side shift (TFF)

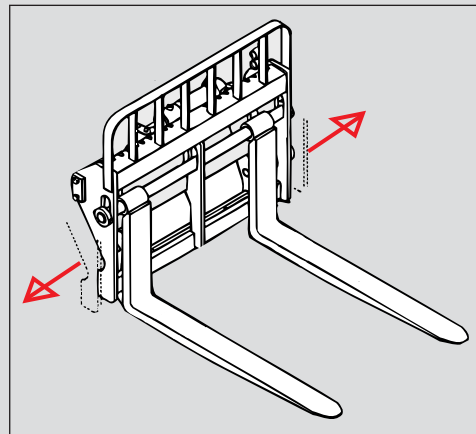

+/- 100 mm of sideways movement

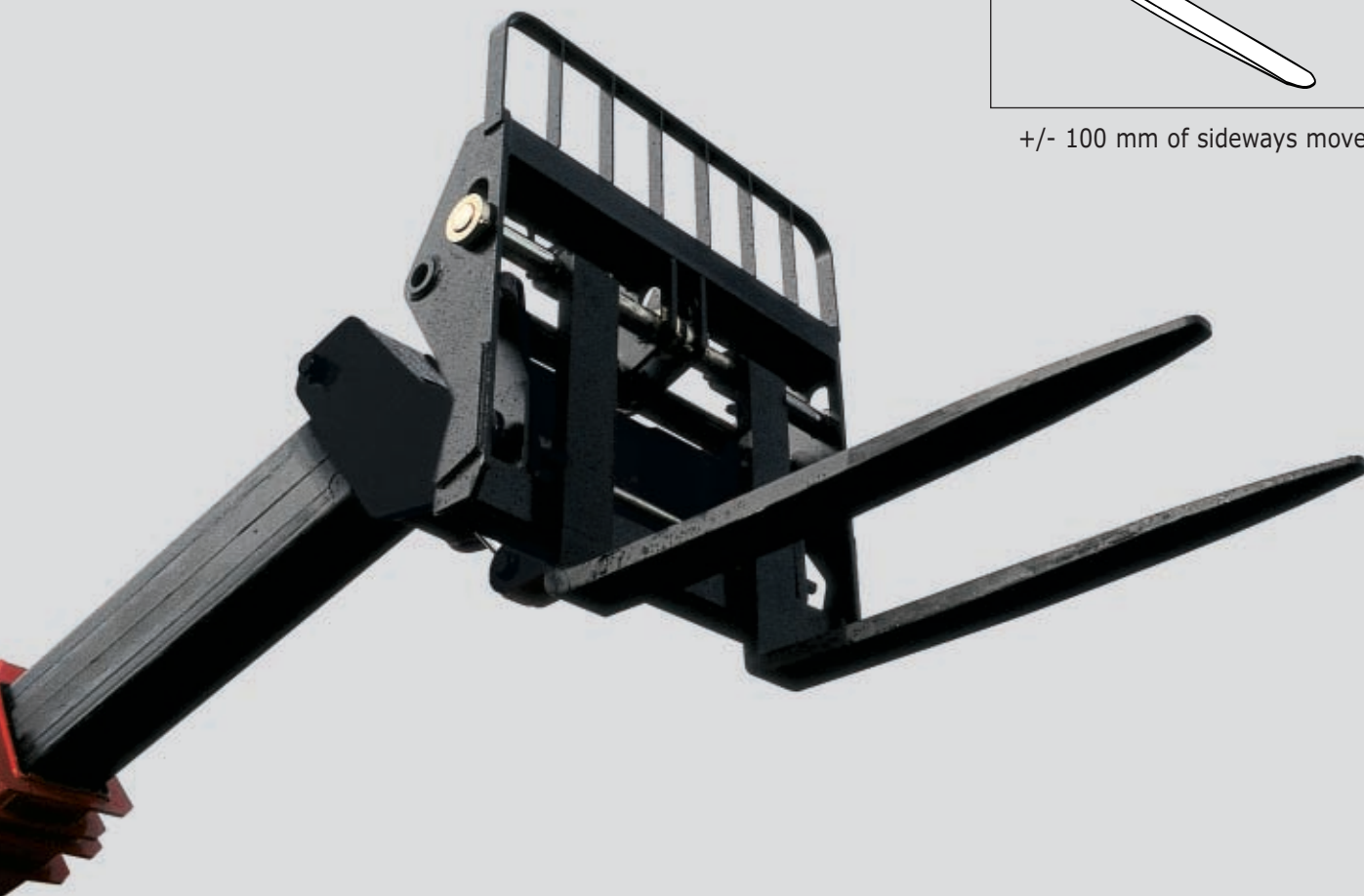

Equipment designed to European standards and to the specifications of your Maniscopic

This is universally appropriate equipment; its dimensions, meeting European standards, make it indispensable for moving pallets of bricks, cement or cladding. Its use is totally unlimited.

Its system of forks is certified according to FEM classifications.

Just like other equipment in the **MANITOU** range, durability and safety are its major features.

Its floating forks and their system of movement make it extremely manageable. It is possible to adjust the forks very precisely, and pick up a pallet from uneven ground. The backboard gives the load great stability and prevents it from slipping backwards.



This carriage also enables you to use other equipment in the **MANITOU** range, such as the concrete skip with spout, and the fork extensions (1.70 m to 2.50 m).



To find out which equipment suits your MANISCOPIC, get in contact with your dealer.  
The specifications shown here are not binding on the manufacturer and may be altered without notice.



# MANISCOPIC

## Equipment

## Grab Bucket (CBG)

- Reinforced construction (base, blade, grab)
- 5 widths: from 1800 to 2450 mm\*
- Wear bushings and greaser nipples on the pivots
- Available with LDR and JFD

\*Depending on the model of MANISCOPIC



Equipment designed to European standards and to the specifications of your Maniscopic



The grab bucket is specially suited for:

- clearing dung heaps
- collecting silage for livestock
- loading bales for strawing down
- collecting compost or vegetable waste

To adapt to each type of load, **2 positions** of grab are possible, giving an impressive grab opening.

With its extremely rugged bucket and the power of its jaws, you will be impressed by its performance whatever you use it for. It is an indispensable multi-purpose tool on any livestock farm.



In addition, you can buy a removable and reversible wearing blade (**LDR**) and a set of closed, removable side-cheeks (**JFD**), to increase the volume of the bucket. A closed grab is also available.

To find out which equipment suits your MANISCOPIC, get in contact with your dealer.  
The specifications shown here are not binding on the manufacturer and may be altered without notice.



# MANISCOPIC

## Equipment

## **Agricultural Bucket (CBA)**

- Guaranteed haulage capacity
- Reinforced construction (base, blade, sides)
- Large capacity: 900 to 3200 litres
- Several widths: from 1500 to 2500 mm\*
- Optional removable and reversible blade

\*Depending on the model of MANISCOPIC



Equipment designed to European standards and to the specifications of your Maniscopic



Specially designed for picking up bulk products, the CBA can be fitted onto any MANISCOPIIC.

It is shaped for fast filling and emptying, to give the user maximum performance.

This is the ideal tool for building a silage clamp, loading a trailer, scraping down a chicken house or collecting cereals.

The reinforced construction of its sides gives it solidity and strength.

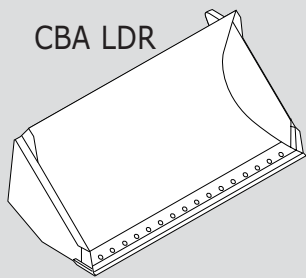

To protect the front edge of the blade from wear, you can choose a removable and reversible blade.



**Warning! You are advised not to use this attachment for earth-moving or picking up bulk materials with a density greater than 0.8.**

To find out which equipment suits your MANISCOPIIC, get in contact with your dealer.  
The specifications shown here are not binding on the manufacturer and may be altered without notice.





# MANISCOPIC Equipment

**Builders  
Bucket  
(CBC)**

- 5 widths
- Height: 804 mm
- From 650 to 900 litres
- 6/8 teeth available\*
- Reinforced construction (base, blade, sides)

\*depending on width



Equipment designed to European standards and to the specifications of your Maniscopic

An effective solution for your earth-moving needs.



Digging...

Specially designed for building work, this bucket will surprise you with its ruggedness.

Its reinforced design guarantees a long working life.



... Earth-moving...

To find out which equipment suits your MANISCOPIC, get in contact with your dealer.  
The specifications shown here are not binding on the manufacturer and may be altered without notice.



**MANITOU BF SA**  
B.P. 249 - 44158 Ancenis Cedex - France  
Tél. : 33 2 40 09 10 11 / Export Department Fax : 33 2 40 09 10 97  
www.manitou.com

700101EN

MODEL	WIDTH	CAPACITY	No. OF TEETH
CBC 650 L 1850	1850 mm	650 L	6
CBC 700 L 1950	1950 mm	700 L	6
CBC 750 L 2100	2100 mm	750 L	6
CBC 800 L 2250	2250 mm	800 L	6
CBC 900 L 2450	2450 mm	900 L	8



... Levelling...

Its negative offset and many teeth enable it to work deep and powerfully.

**- Anything is possible!**



# **MANISCOPIC** **Equipment**

**Materials  
Handling  
(CBR)**

- 5 widths
- Height 775 mm
- From 730 to 1000 litres
- Reinforced construction (base, blade, sides)



Equipment designed to European standards and to the specifications of your Maniscopic

This bucket, a happy medium between the agricultural and the builder's bucket, is designed for picking up materials with densities greater than 1 (soil, sand, stones).

The pick-up bucket is fitted with 4 very strong side reinforcements, guaranteeing an exceptionally long working life.

<b>MODELS</b>	<b>WIDTH</b>	<b>CAPACITY</b>
<b>CBR 730 L 1850</b>	<b>1850 mm</b>	<b>730 L</b>
<b>CBR 780 L 1950</b>	<b>1950 mm</b>	<b>780 L</b>
<b>CBR 850 L 2100</b>	<b>2100 mm</b>	<b>850 L</b>
<b>CBR 900 L 2250</b>	<b>2250 mm</b>	<b>900 L</b>
<b>CBR 1000 L 2450</b>	<b>2450 mm</b>	<b>1000 L</b>



It also has a wide digging angle making it easy to pick up and tip building materials. It is also the ideal tool for clearing building sites.



To find out which equipment suits your MANISCOPIC, get in contact with your dealer. The specifications shown here are not binding on the manufacturer and may be altered without notice.



# MANISCOPIC Equipment

## ■ *Manure Fork With Adjustable Grab (FFGR)*

- 4 widths (1700, 1950, 2100 and 2400 mm\*)
- Removable fingers
- 4-position grab
- Very rugged design
- Wear bushings and grease nipples

\*depending on the model of MANISCOPIC



Equipment designed to European standards and to the specifications of your Maniscopic

Specially suited to the work of collecting manure, you will find this fork surprisingly comfortable to use and very durable in design: a welded box construction special to **MANITOU**.



Its grab is adjustable to 4 positions, allowing you to increase the volume of dung taken up.

Each pivot is fitted with a wear bushing and a grease nipple for regular maintenance.

In addition, by removing the fingers on their bayonet fittings you can also manipulate straw bales.

With this machine, a muck-spreader can be loaded in record time, or cowsheds mucked out without changing attachments.

Our design allows you to order the grab separately.

The fork with adjustable grab is delivered with a pressure regulator, flexible hoses and quick-fit connectors.



To find out which equipment suits your MANISCOPIIC, get in contact with your dealer.  
The specifications shown here are not binding on the manufacturer and may be altered without notice.



# MANISCOPIC

## Equipment

### ■ Bale Clamp

- Suitable for round and wrapped bales
- Reinforced tubular chassis
- Closes hydraulically with double action ram



Equipment designed to European standards and to the specifications of your Maniscopic

This indispensable attachment for handling round or rectangular bales adapts onto any MANISCOPIC.

With its double action ram which closes the jaws hydraulically, you can easily manipulate any size of round bales up to 1.80 m diameter.

There is also an optional special clamp for bales larger than 1.80 m diameter.



A second carrying clamp can be added, to form a two-bale clamp; an electric valve with pressure regulator enables the bales to be picked up independently.

Also available, a clamp for wrapped bales with easy-release free arms centring on the bale.



To find out which equipment suits your MANISCOPIC, get in contact with your dealer.  
The specifications shown here are not binding on the manufacturer and may be altered without notice.





- Easy connection
- Turning angles: 90° to left or right
- Hydraulic and electrical connectors for the trailer (option)



Equipment designed to European standards and to the specifications of your Maniscopic

If you need to load a conventional or flatbed trailer, and then tow it back, **MANITOU** offers you three different attachments.

## 1) Projecting spindle

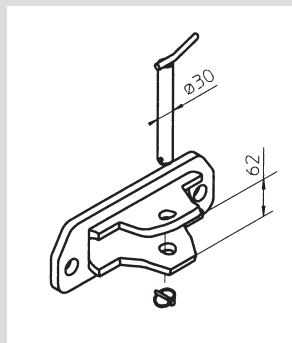

Simple to use, this one is designed for occasional trailer towing.

- Maximum turning angle: 90° left/right
- Maximum exterior diameter of the towing ring: 130 mm

	MLT 523		MLT 526		MLT 6/7/8/9	
Tyres	18"	20"	24"	20"	24"	
Ground clearance of the hook (mm)	480	560	640	465	545	

## 2) Hydraulic hook

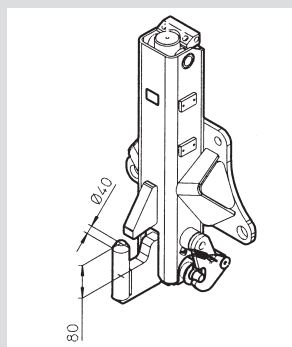

This one enables you to hitch a trailer without leaving the driving seat, thanks to a distributor placed in the cab.

- Maximum turning angle: 90° left/right
- Maximum exterior diameter of the towing ring: 130 mm
- Movement of the hook: 350 mm
- Can be unlocked from the cab
- Max. pressure: 260 b



Two catches lock the hook in place.

	MLT 523		MLT 526		MLT 6/7/8/9	
Tyres	18"	20"	24"	20"	24"	
Ground clearance of the hook, top position (mm)	X	580	660	590	670	
Ground clearance of the hook, bottom position (mm)	X	230	310	240	320	

## 3) Hitching ladder

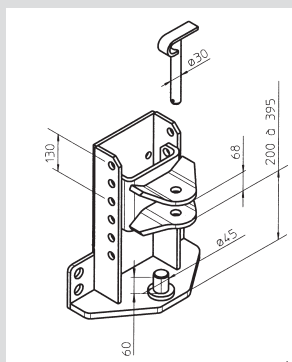

The hitching ladder with fixed ring offers 4 adjustment heights. It can be used to hitch a trailer easily, using the optional rear-view mirror placed on the rear of the machine.

- Maximum turning angle: 90° left/right on clevis and ring
- Maximum exterior diameter of the towing ring: 130 mm

	MLT 523		MLT 526		MLT 6/7/8/9	
Tyres	18"	20"	24"	20"	24"	
Ground clearance of the hook (mm)	405	485	565	455	535	

\* As an option, you can have a rear hydraulic single or double action take-off, hydraulic power braking, an electrical socket, number-plate light and a rear-view mirror.  
On-road towing has never been so carefree!

To find out which equipment suits your MANISCOPIC, get in contact with your dealer.  
The specifications shown here are not binding on the manufacturer and may be altered without notice.



# MANISCOPIC Equipment

## Concrete Skips

- 2 models available
- Precise tipping
- Manual or hydraulic opening
- Hooks onto forks or standard carriage
- Optional removable directional pouring (BB 500)



Equipment designed to European standards and to the specifications of your Maniscopic

Concrete skips are ideal for transferring concrete from the mixer to the point of use, offering very high efficiency and great precision.

**MANITOU** can supply two types of concrete skips:



BB 500

### BB 500/BB 500 H

- Height: 730 mm
- Capacity: 500 L (1300 kg)
- Fits under the concrete mixer
- Manual or hydraulic opening (option)
- Directly attached or lifted on forks
- Tips to front or side
- Weight: 200 kg

### CONCRETE SKIP WITH SPOUT

- 6 capacities: from 300 to 1500 L
- Manual or hydraulic opening (option)
- Lifted with forks or by winch
- Tips to front or side
- Precision tipping
- Weight: from 150 kg to 350 kg



GL 600



### BBH/GLH: HYDRAULIC OPENING

There is an optional hydraulic kit for opening the spout, consisting of a ram, connectors and flexible hoses.

To find out which equipment suits your MANISCOPIC, get in contact with your dealer.  
The specifications shown here are not binding on the manufacturer and may be altered without notice.



# MANISCOPIC

**Equipment**

## ■ Crane Jibs

- Capacity 600 kg
- Hook onto standard carriage
- Reinforced construction
- Available with a winch



Equipment designed to European standards and to the specifications of your Maniscopic

Fit your MANISCOPIC with a crane jib, and you obtain substantial lift capacity for handling heavy and bulky loads. You will be able to position loads in places that are difficult to access using conventional means.

In all situations, the reinforced construction and the closed hook guarantee perfect safety in use.



P 600 MT

### P 600 MT

CAPACITY:	600 kg
LENGTH:	4024 mm
WIDTH:	830 mm
HEIGHT:	814 mm
WEIGHT:	170 kg

### PT 600 MT

CAPACITY:	600 kg
LENGTH:	4024 mm
WIDTH:	830 mm
HEIGHT:	814 mm
WEIGHT:	288 kg

CAPACITY OF THE DRUM:	52 m
DIAMETER OF THE CABLE:	7.5 mm
SPEED:	38 to 48 metres/min



PT 600 MT

### WARNING!

When manipulating suspended loads, you must use the automatic cut-out to protect from dangerous movements.

To find out which equipment suits your MANISCOPIC, get in contact with your dealer.  
The specifications shown here are not binding on the manufacturer and may be altered without notice.



# MANISCOPIC

## Equipment

### ■ *Swivel Jib*

- 3 models
- Hooks onto standard carriage
- Swivels 15°/15°
- Reinforced construction



Equipment designed to European standards and to the specifications of your Maniscopic

Fit your MANISCOPIIC with a crane jib, and you obtain substantial lift capacity for handling heavy and bulky loads. You will be able to place loads in places that are difficult to access using conventional means.

In all situations, the reinforced construction and the closed hook guarantee perfect safety in use.

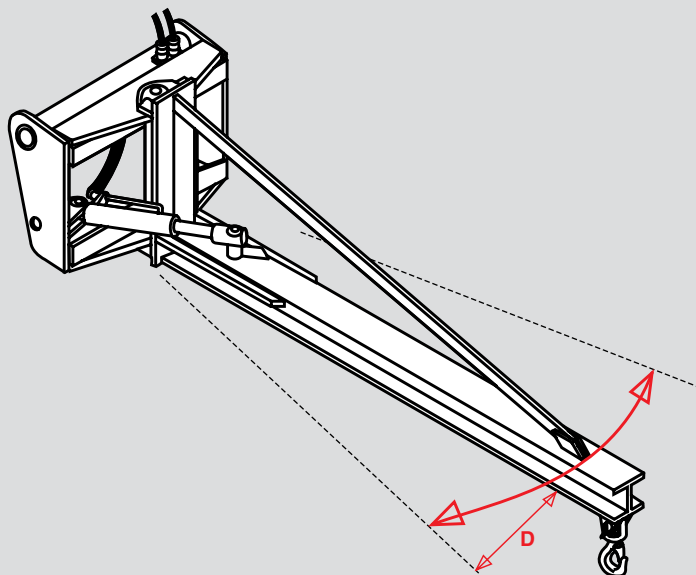

... steer the load with the swivel jib...

MODEL	LENGTH	CAPACITY	SIDWAYS SWIVEL	OFFSET D	WEIGHT
PO 600 MT	2500 mm	600 kg	15°/15°	+/- 650 mm	280 kg
PO 1000 MT	1500 mm	1000 kg	15°/15°	+/- 320 mm	230 kg
PO 2000 MT	1000 mm	2000 kg	15°/15	+/- 260 mm	210 kg

**WARNING!**

When manipulating suspended loads, you must use the automatic cut-out to protect from dangerous movements.

To find out which equipment suits your MANISCOPIIC, get in contact with your dealer.  
The specifications shown here are not binding on the manufacturer and may be altered without notice.





# MANISCOPIC Equipment

## ■ Crane Jibs With Hooks

- 2 models
- Hook onto standard carriage
- Fixed and closed hooks
- Capacities from 1,200 to 5,000 kg



Equipment designed to European standards and to the specifications of your Maniscopic

Fit your MANISCOPIE with a crane jib, and you obtain substantial lift capacity for handling heavy and bulky loads. You will be able to position loads in places that are difficult to access using conventional means.

In all situations, the reinforced construction and the closed hook guarantee perfect safety in use.

With the range of **MANITOU** crane jibs with hooks, many operations can be undertaken:

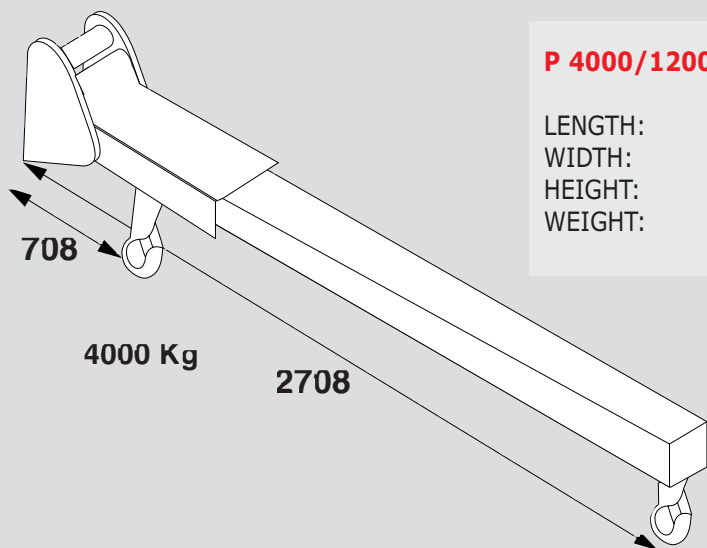

**P 4000/1200 MT (2 fixed hooks)**

LENGTH: 2838 mm  
 WIDTH: 830 mm  
 HEIGHT: 467 mm  
 WEIGHT: 210 kg

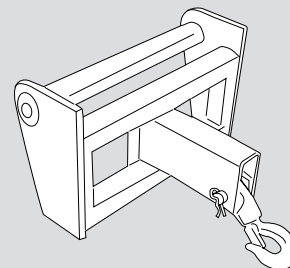

**MODEL CAPACITY**

MODEL	CAPACITY
PC 30	3,000 kg
PC 40	4,000 kg
PC 50	5,000 kg

**1200 Kg**



... manipulate bulky loads with the P 4000 MT jib with hook...



... manipulate heavy loads with the PC 50 jib with hook...

**WARNING!**

**When manipulating suspended loads, you must use the automatic cut-out to protect from dangerous movements.**

To find out which equipment suits your MANISCOPIE, get in contact with your dealer.  
 The specifications shown here are not binding on the manufacturer and may be altered without notice.

